

The Basin

16X76 4x4 KITCHEN UNIT

LMWFH167644BN

**THE
LANDMAN
SERIES**

**TITAN
FACTORY DIRECT**



- 8ft Sidewalls
- Flat Ceilings
- Thermal Pane Windows
- 55 Year Siding
- Steel Faucets
- Porcelain Sinks
- R Panel Metal Corrugated Roof
- 2x4 Interior Insulated Walls

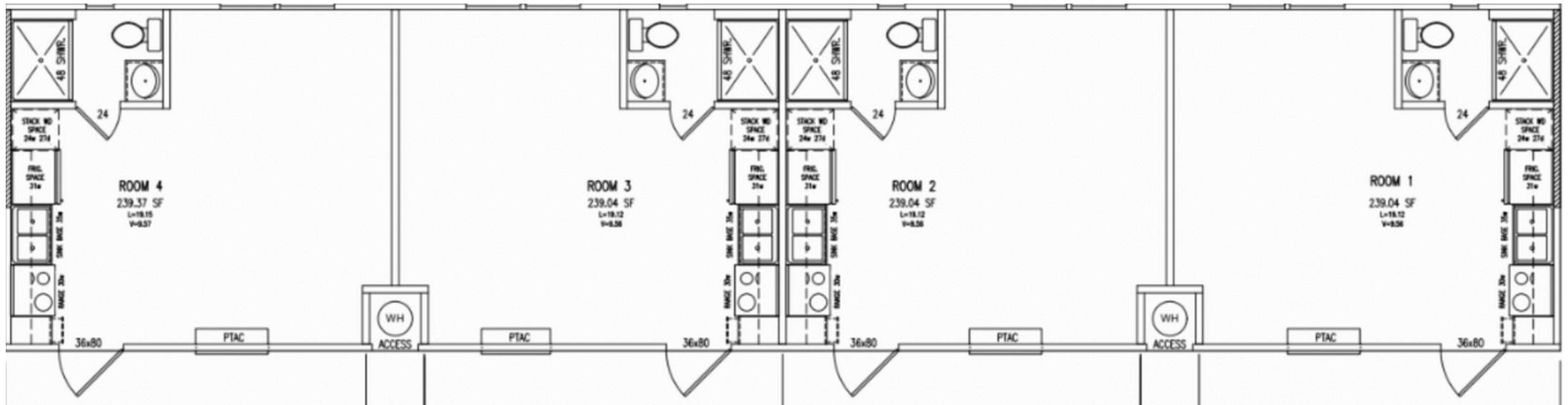

*workforce housing intended for TX H2A program

STANDARD SPECIFICATIONS

**All specifications are subject to change*

Workforce housing intended for TX H2A program

**THE
LANDMAN
SERIES**

TITAN
FACTORY DIRECT

INTERIOR SPECIFICATIONS

INTERIOR

- 2x6 Engineered Joist
- 2x4 Interior Walls
- 8' Foot Sidewalls
- High Gage Vinyl Flooring Throughout
- Knockdown Ceilings
- Flat Ceilings
- Rolled Edge Formica Countertops
- 3/8 Vinyl Covered Sheetrock Throughout
- 3" Vinyl Wrapped Flat Luan Trim
- R Value Insulation R-11 Walls -R11 Floors R-22 Ceiling
- 6 Panel Interior Doors
- 2" mini blinds
- Privacy Door Locks in Bathrooms and Master BR
- Brushed Nickel Ceiling Fans in LR & Master BR
- 42" Kitchen Cabinets
- Wire Shelving in Closets
- Washer / Dryer Hookups
- Ceiling fans in LR and Master Bedroom

WET AREAS

- 40 Gal HWT
- Double Bowl SS Sink
- 18 cu ft Refrigerator
- Coil Top Range
- Built-in Vented Microwave
- Dishwasher
- Porcelain Lavatory
- Brushed Nickle Faucets in all Baths
- Fiberglass Showers and Tubs (HUD ONLY)
- Elongated Toilets
- Vanity Bar Lights in Bathrooms
- 24 x 36 Mirrors in Baths
- 50 CFM Exhaust Fan

ELECTRICAL

- 20-amp Weatherproof Exterior GFI Recep
- GFI In Bathrooms and Kitchen Countertops
- 15-amp 125V Single Pole Switch
- Interconnected Smoke Detector with Battery Backup 40 Amp Disconnect Box
- 200 Amp Interior Panel Box
- Complete with Interior Furnace
- Buyer provides A-coil, line set, and outside condenser
- Exterior Porch Lights at Entrances LED
- Can lights LR/Kitchen/DR

EXTERIOR SPECIFICATIONS

- Frame, Roofing, Siding and Windows:
- Detachable Hitch
- 3 on 12 Gable Pitch (Slope to Sides) w/ 6" vented eve.
- R Panel Metal roof
- 7/16 OSB Roof Decking
- 55 Year Smart Panel Siding
- Exterior Electrical Plug
- 40 Amp AC Disconnect Box
- 2x6 Rim Joist
- Engineered Trusses
- 5/8" OSB Tounge/Grove Floors
- 2 x 4 Exterior Walls
- 36"x 80" House Type Front Door w/ Storm Door
- 9 Light Rear Cottage Door
- Grade 2 Privacy Knob Set
- Access to Water Heaters
- Vinyl Low Emission Thermal Pane Windows
- House Wrap Under Exterior Siding
- Flashing Tape Around Windows and Doors
- 5000 LB Brake and Idler Axles
- Exterior Water Spigot